

**CALENDAR ITEM
C18**

A 4
S 1

10/19/12
PRC 4140.1
R. Boggiano

REVISION OF RENT

LESSEE:

LLC of Wallace and Janet Breuner

AREA, LAND TYPE, AND LOCATION:

Sovereign land in Lake Tahoe, adjacent to 4990 West Lake Boulevard, near Homewood, Placer County.

AUTHORIZED USE:

Continued use and maintenance of an existing pier and one mooring buoy.

LEASE TERM:

10 years, beginning February 1, 2005.

CONSIDERATION:

This lease provides that the State may modify the rent periodically during the lease term. Pursuant to this provision, staff conducted a review of the rent under this lease and recommends rent be revised from \$234 per year to \$924 per year, effective February 1, 2013.

OTHER PERTINENT INFORMATION:

1. On February 1, 2005, the Commission authorized a General Lease – Recreational Use to the LLC of Wallace and Janet Breuner, for a term of 10 years. The Lease will expire on January 31, 2015. Staff conducted the rent review called for in the lease and recommends that the rent be increased.
2. The staff recommends that the Commission find that the subject revision of rent does not have a potential for resulting in either a direct or a reasonably foreseeable indirect physical change in the environment, and is, therefore, not a project in accordance with the California Environmental Quality Act (CEQA).

CALENDAR ITEM NO. **C18** (CONT'D)

Authority: Public Resources Code section 21065 and California Code of Regulations, Title 14, sections 15060, subdivision (c)(3), and 15378.

EXHIBIT:

- A. Site and Location Map

RECOMMENDED ACTION:

It is recommended that the Commission:

CEQA FINDING:

Find that the subject revision of rent is not subject to the requirements of CEQA pursuant to California Code of Regulations, Title 14, section 15060, subdivision (c)(3), because the subject activity is not a project as defined by Public Resources Code section 21065 and California Code of Regulations, Title 14, section 15378.

AUTHORIZATION:

Approve the revision of rent for Lease No. PRC 4140.1 from \$234 per year to \$924 per year, effective February 1, 2013.

NO SCALE

SITE

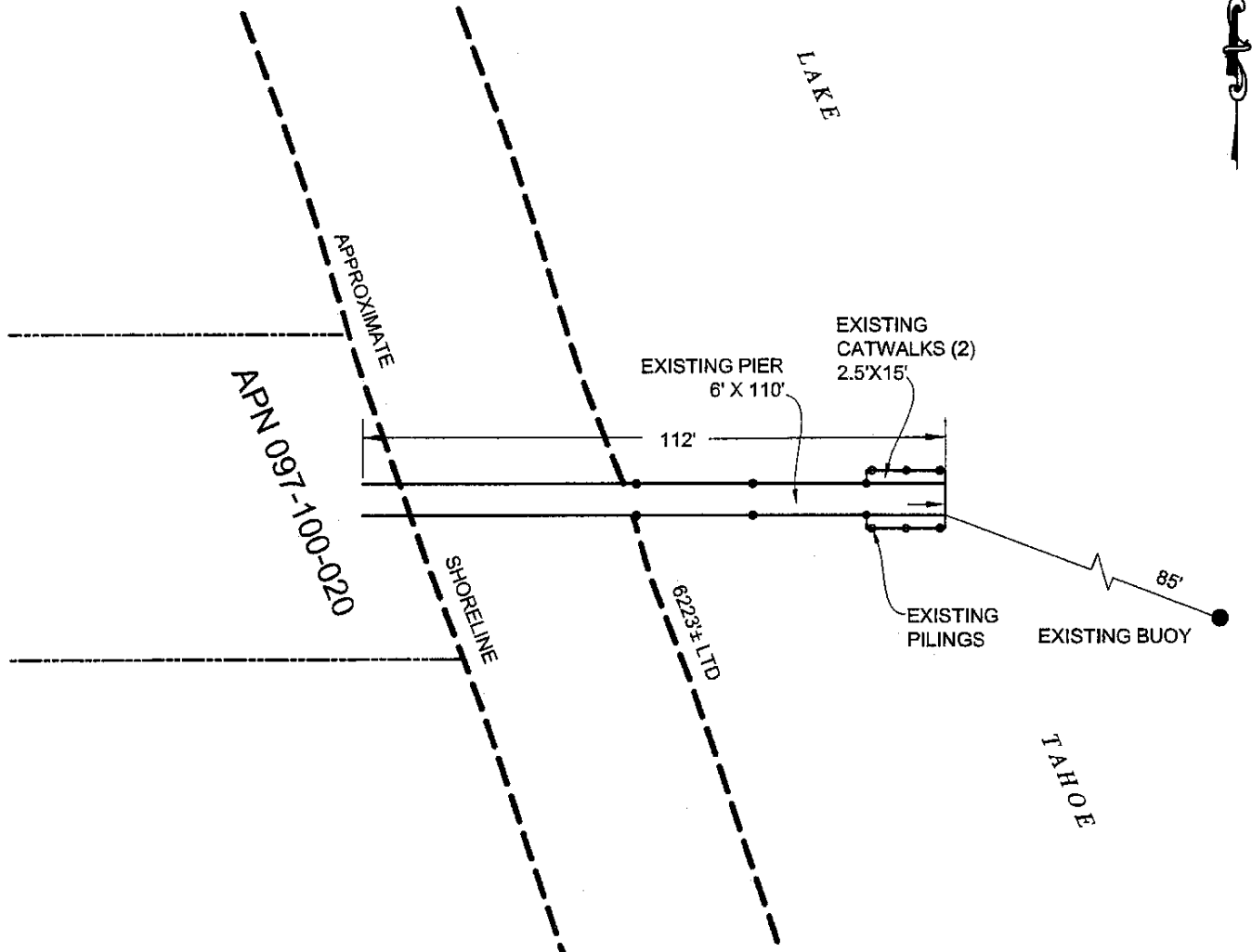

4990 WEST LAKE BLVD., NEAR HOMEWOOD

NO SCALE

LOCATION

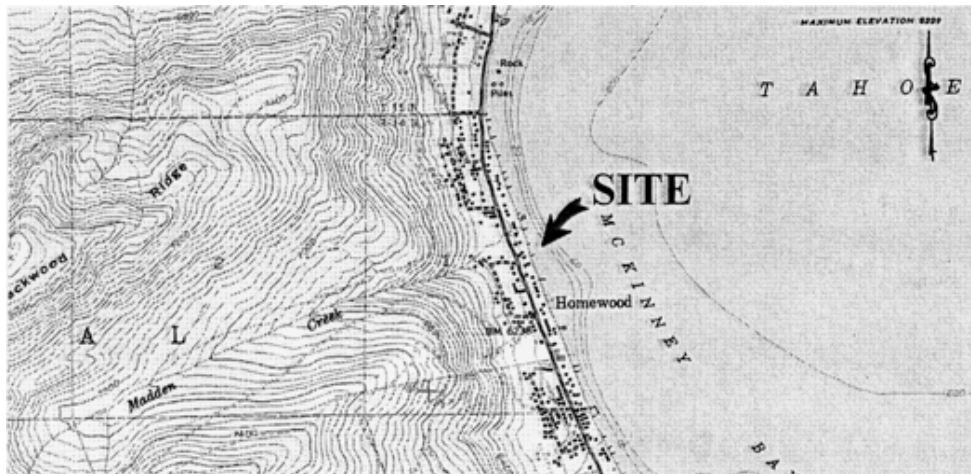

MAP SOURCE: USGS QUAD

Exhibit A

PRC 4140.1
 BREUNER
 APN 097-100-020
 GENERAL LEASE -
 RECREATIONAL USE
 PLACER COUNTY

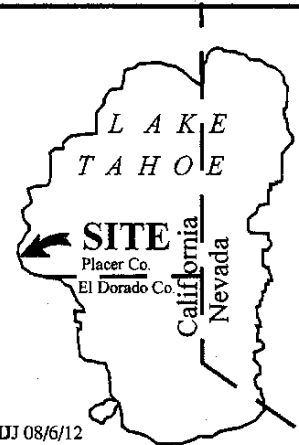

MJJ 08/6/12

This Exhibit is solely for purposes of generally defining the lease premises, is based on unverified information provided by the Lessee or other parties and is not intended to be, nor shall it be construed as, a waiver or limitation of any State interest in the subject or any other property.