

**CALENDAR ITEM  
C92**

A 31  
S 12

04/23/15  
PRC 7410.1  
D. Simpkin

**REVISION OF RENT**

**LESSEE:**

California Gas Gathering, Inc.

**AREA, LAND TYPE, AND LOCATION:**

Sovereign land in the bed of the San Joaquin River, near Mendota, Fresno and Madera Counties.

**AUTHORIZED USE:**

The operation and maintenance of an existing six-inch diameter natural gas pipeline.

**LEASE TERM:**

30 years, beginning July 1, 1990.

**CONSIDERATION:**

This lease provides that Lessor may modify the rent periodically during the lease term. Pursuant to this provision, staff has conducted a review of the rent under this lease and recommends that rent be revised from \$100 per year to \$450 per year, effective July 1, 2015.

**OTHER PERTINENT INFORMATION:**

1. On June 11, 1990, the Commission authorized a General Lease – Right-of-Way Use to California Gas Gathering, Inc. for the operation of a six-inch diameter natural gas pipeline.
2. Staff conducted the rent review called for in the Lease and recommends that the annual rent be increased.
3. The staff recommends that the Commission find that the subject revision of rent does not have a potential for resulting in either a direct or a reasonably foreseeable indirect physical change in the environment, and is, therefore, not a project in accordance with the California Environmental Quality Act (CEQA).

CALENDAR ITEM NO. **C92** (CONT'D)

**EXHIBIT:**

A. Site and Location Map

**RECOMMENDED ACTION:**

It is recommended that the Commission:

**CEQA FINDING:**

Find that the subject revision of rent is not subject to the requirements of CEQA pursuant to California Code of Regulations, Title 14, section 15060, subdivision (c)(3), because the subject activity is not a project as defined by Public Resources Code section 21065 and California Code of Regulations, Title 14, section 15378.

**AUTHORIZATION:**

Approve the revision of rent for Lease No. PRC 7410.1 from \$100 per year to \$450 per year, effective July 1, 2015.

NO SCALE

### SITE

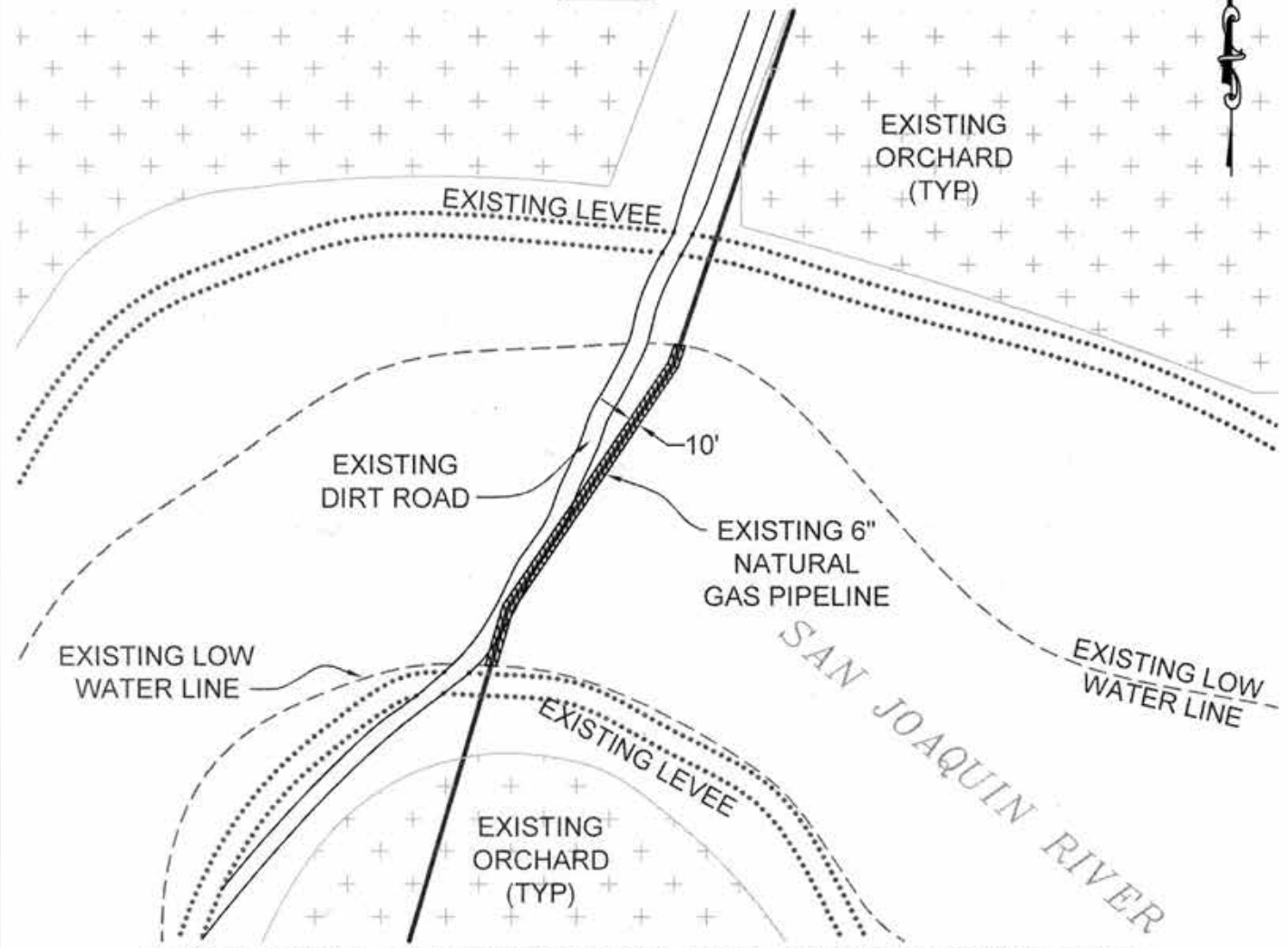

CALIFORNIA GAS GATHERING, INC., SAN JOAQUIN RIVER

NO SCALE

### LOCATION



MAP SOURCE: USGS QUAD

### **Exhibit A**

PRC 7410.1  
 CALIFORNIA GAS GATHERING, INC.  
 GENERAL LEASE -  
 RIGHT-OF-WAY USE  
 FRESNO / MADERA  
 COUNTY



This Exhibit is solely for purposes of generally defining the lease premises, is based on unverified information provided by the Lessee or other parties and is not intended to be, nor shall it be construed as, a waiver or limitation of any State interest in the subject or any other property.