

**CALENDAR ITEM
C11**

A 3
S 4

10/13/16
PRC 1929.9
M. Schroeder

**ACCEPTANCE OF A QUITCLAIM DEED
AND ISSUANCE OF A GENERAL LEASE – PUBLIC AGENCY USE**

PERMITTEE:

County of Sutter

APPLICANT:

City of Yuba City

PROPOSED LEASE:

AREA, LAND TYPE, AND LOCATION:

Sovereign land in the Feather River, adjacent to 563 2nd Street, city of Yuba City, Sutter County and River Front Park, city of Marysville, Yuba County.

AUTHORIZED USE:

Construction, use, and maintenance of a new bridge, known as the Fifth Street Bridge, with attached City-operated utility conduits and a 12-inch-diameter water line; use of a temporary construction easement; temporary use and maintenance of the existing Fifth Street Feather River Bridge (No. 18C-0012), also known as the Twin Cities Memorial Bridge; and the demolition and removal of the existing bridge and concrete piers.

LEASE TERM:

25 years, beginning October 13, 2016.

CONSIDERATION:

The public use and benefit; with the State reserving the right at any time to set a monetary rent if the Commission finds such action to be in the State's best interests.

SPECIFIC LEASE PROVISIONS:

1. Lessee shall not place, attach, or authorize the placement of any utilities or other improvements on the Bridge or within the Lease Premises without the Lessor's prior review and approval. Separate

CALENDAR ITEM NO. **C11** (CONT'D)

leases or subleases are required and shall be obtained for all utilities not operated by Lessee.

2. Lessee shall place warning signage and/or buoys, clearly visible from the shore and in the water, both upstream and downstream of the construction site, to provide notice of the bridge replacement project and to advise the public to exercise caution. Lessee shall place and maintain such signage at all times during bridge removal and construction activities, and shall notify the California Department of Parks and Recreation's Division of Boating and Waterways of the location, description, and purpose of such signage upon its installation and removal.
3. Lessee shall install signs directing the public to the nearby Yuba City Boat Launch facility, Feather River Parkway, and Veterans Memorial Park, which are located adjacent to the Lease Premises, for public access to the Feather River.

STAFF ANALYSIS AND RECOMMENDATION:

Authority:

Public Resources Code sections 6005, 6216, and 6301; California Code of Regulations, title 2, section 2000, subdivision (b).

Lease History and Project Description:

On July 15, 1957, the Commission authorized a Public Agency Permit to the County of Sutter for the construction, use and maintenance of the existing Fifth Street Feather River Bridge ([Minute Item 27, July 15, 1957](#)). That permit expires at the end of life of the bridge. The County of Sutter has submitted a quitclaim deed for the existing permit and requests its acceptance. The Fifth Street Feather River Bridge over the Feather River was historically owned by the County of Sutter and was built in 1958. The City of Yuba City (City) has since taken over operation and maintenance of the Fifth Street Feather River Bridge and has submitted an application for a General Lease – Public Agency Use for the construction, use, and maintenance of a new Fifth Street Feather River Bridge with City-operated utility conduits and a 12-inch-diameter water line, use of a temporary construction easement, temporary use and maintenance of the existing Fifth Street Feather River Bridge (No. 18C-0012), also known as the Twin Cities Memorial Bridge; and the demolition and removal of the existing bridge and concrete piers (Lease or Project). The City has the right to use the uplands adjoining the lease premises.

CALENDAR ITEM NO. **C11** (CONT'D)

In 2011, the California Department of Transportation (Caltrans) determined the existing Fifth Street Feather River Bridge to be structurally deficient and seismically inadequate under Federal Highway Administration prescribed inspection criteria. As a result, the bridge will be replaced. The proposed bridge replacement over the Feather River will provide an improved transportation network between the City of Yuba City and the city of Marysville. The proposed bridge would be approximately 1,885 feet long and 76.5 feet wide, with 10 spans. Approximately 426.94 feet of the bridge and three of the spans will be located on or over sovereign land in the bed of the Feather River. The proposed spans will be constructed of cast-in-place post-tensioned concrete box girder on concrete piers. Each concrete pier includes three 7-foot-diameter columns and each column is founded on a 10-foot-diameter cast-in-steel shell or cast-in-drilled-hole concrete pile. The width allows up to four traffic lanes, shoulders on both sides, a median barrier, a pedestrian and bicycle path and barrier on the north side of the bridge, utility conduits, and a 12-inch-diameter city water line. The proposed bridge will be wider with a curved horizontal alignment to separate the new bridge from the existing bridge and utilize the same touchdown locations in the city of Yuba City and the city of Marysville. The proposed lease premise encompasses the right-of-way for the existing bridge.

On December 18, 2015, the Commission authorized a General Lease – Right-of-Way Use to CVIN, LLC (CVIN), for a 4-inch-diameter galvanized steel casing conduit, carrying two, 1.25-inch-diameter high density polyethylene fiber optic cables attached to the existing Fifth Street Feather River Bridge ([Calendar Item C05, December 18, 2015](#)). As part of the project, the City proposes to relocate the conduit onto the proposed bridge. Staff will request an application from CVIN for a lease amendment to include the new location for the conduit. Two other utility conduits, one for AT&T and the other for Comcast Corporation utilities, are attached to the existing bridge and are proposed for reattachment to the new bridge. The existing utilities are not currently authorized by the Commission. The City will provide conduits for these facilities but does not want them to be part of the proposed lease. AT&T and Comcast Corporation understand that they must submit applications for separate leases and that the utilities cannot be installed without Commission approval.

Construction of the proposed bridge is planned to be completed over two stages. In stage one construction, traffic will continue to be carried by the existing bridge while the concrete piles and columns, along with an

CALENDAR ITEM NO. **C11** (CONT'D)

approximately 600-foot portion of the proposed bridge, is built adjacent to and north of the existing bridge. In stage two construction, the remaining portions of the proposed bridge will be built and traffic will be moved from the existing bridge to the new bridge. Thereafter, the existing bridge will be demolished. Construction within the Feather River will be limited to the period between June 1 and October 1 to minimize impacts to Central Valley Chinook Salmon, California Central Valley steelhead, and North American green sturgeon.

Temporary trestles will be utilized during construction of the new bridge and removal of the existing bridge and will be utilized in two stages, concurrent with the staging of construction. The trestles will be fully removed once construction is complete. The existing structure will be removed in its entirety including removal of the concrete piers.

Removal of the concrete piers located in the Feather River will require a temporary two-part water diversion utilizing temporary water-inflated dams, portable dams or utilization of sheet piles to create a cofferdam (or equivalent approach) to facilitate existing bridge removal, with the exception that the concrete piers may be cut off five feet below the mud line and left in place if the City is unsuccessful in its attempts to remove the concrete piers completely. In the event the City is unable to completely remove the concrete piers, the City will remain responsible for any abandoned structures. At the option of the Commission, the City of Yuba City will be required to submit an application for a lease amendment to implement an Abandonment Agreement. Should the Commission determine that any abandoned structures have become a hazard to the public, the City will be required to remedy the hazard. The riverbed and banks will be returned to their original condition upon completion of construction activities.

The City, as the Lead Agency, adopted a Mitigated Negative Declaration for the Fifth Street Bridge Replacement project in August 2014 (SCH # 2013082011). The Commission is now considering approval of the Lease as a Responsible Agency under the California Environmental Quality Act (CEQA). The proposed lease incorporates those elements of the Mitigation Monitoring Program adopted by the City that fall within the jurisdiction of the Commission as contained in the attached Exhibit C.

CALENDAR ITEM NO. **C11** (CONT'D)

Public Trust and State's Best Interests Analysis:

Promotion of public access to and use of California's navigable waters is a mandate of the California Constitution (Article 10, Section 4), a condition of statehood in the Act of Admission (Vol. 9, Statutes at Large, page 452), and a responsibility of all involved public agencies pursuant to the common law Public Trust Doctrine. As part of the project action, on August 16, 2016, the City Council of the City of Yuba City: 1) adopted a Feasibility Study prepared by Dokken Engineering pursuant to California Streets and Highways Code section 1809 on the feasibility of providing public access to the waterway for recreational purposes as part of the Fifth Street Bridge replacement project and; 2) determined there are four existing public access facilities identified as Riverfront Park in the city of Marysville; Yuba City Boat Launch facility, Feather River Parkway, and Veterans Memorial Park; the latter three access points are located in the City of Yuba City. There currently exists numerous unimpeded access points to the east and west bank of the Feather River adjacent to the lease premises, from River Front Park and the Feather River Parkway. Brief restrictions on access to and under portions of the river are expected during construction and demolition for purposes of public safety; however, it is expected that navigation on the river will not be impeded.

The existing bridge has existed for many years at this location. Furthermore, the existing and proposed bridge do not significantly alter the land, the lease does not alienate the State's fee simple interest, and neither permanently impairs public rights. The lease is limited to a 25-year term, does not grant the lessee exclusive rights to the lease premises, and reserves an easement to the public for Public Trust consistent uses. Upon termination of the lease, the lessee may be required to remove all improvements from State lands. Therefore, temporary continued use of the existing bridge and use of the proposed bridge is not inconsistent with the Public Trust values of the subject parcel.

For the reasons stated above, Commission staff believes the issuance of this lease will not substantially interfere with Public Trust needs at this location, at this time, and for the foreseeable term of the proposed lease, is consistent with the common law Public Trust Doctrine, and is in the best interests of the State.

Greenhouse Gas and Climate Change Analysis:

The City adopted a Mitigated Negative Declaration for the Fifth Street Bridge Replacement project in August 2014. Within that document, the

CALENDAR ITEM NO. **C11** (CONT'D)

City chose to adopt the Caltrans standards for assessing impacts to climate change under CEQA. The City provided a brief explanation of state and federal strategies that are being implemented to reduce greenhouse gas (GHG) emissions from transportation sources, and noted that neither the U.S. Environmental Protection Agency nor the Federal Highway Administration has promulgated explicit guidance or methodology to conduct project-level GHG analysis.

While the Mitigated Negative Declaration disclosed that construction would result in a slight increase in GHG emissions, the City determined that in the absence of further regulatory or scientific information related to GHG emissions and CEQA significance, it was too speculative to make a significance determination regarding the project's direct impact and its contribution on the cumulative scale of climate change.

An Air Quality Report was prepared for the Fifth Street Bridge Replacement project in October 2011, using URBEMIS 2007 (Urban Emissions) Version 9.2.4, and it quantified carbon dioxide emissions from construction activities for each project year anticipated at the time:

- 277.69 metric tons (2014)
- 380.02 metric tons (2015)
- 118.73 metric tons (2016)

The Feather River Air Quality Management District (FRAQMD) has not established a CEQA threshold of significance for GHG emissions and provides no guidance referring a CEQA lead or responsible agency to other adopted thresholds to measure the significance of GHG emissions from land use or construction projects. In the absence of the CEQA lead agency or FRAQMD determination, the Commission must decide whether the GHG emissions from the activities occurring under its jurisdiction will have a potentially significant impact on climate change.

For this project, Commission staff recommends relying upon the Sacramento Metropolitan Air Quality Management District's (SMAQMD) GHG thresholds adopted in October 2014. These thresholds were developed with a regional perspective and are in compliance with expert advice from the California Air Pollution Control Officers Association.

CALENDAR ITEM NO. **C11** (CONT'D)

SMAQMD's guidance includes an adopted threshold of 1,100 metric tons of carbon dioxide equivalent (CO₂e) per year. As noted above, the project's construction and demolition emissions were calculated to be no higher than 380.02 metric tons during any year. Therefore, the anticipated GHG emissions from the project's construction activities are less than significant, and no CEQA mitigation to offset impacts to climate change is required.

OTHER PERTINENT INFORMATION:

1. This action is consistent with Strategy 1.1 of the Commission's Strategic Plan to deliver the highest levels of public health and safety in the protection, preservation, and responsible economic use of the lands and resources under the Commission's jurisdiction and Strategy 1.3 to protect, expand, and enhance appropriate public use and access to and along the State's inland and coastal waterways.
2. Acceptance of the quitclaim deed is not a project as defined by CEQA because it is an administrative action that will not result in direct or indirect physical changes in the environment.

Authority: Public Resources Code section 21065 and California Code of Regulations, title 14, section 15378, subdivision (b)(5).

3. A Mitigated Negative Declaration, State Clearinghouse No. 2013082011, was prepared by the City of Yuba City and adopted on August 19, 2014, for this project. The California State Lands Commission staff has reviewed such document.
4. A Mitigation Monitoring Program was adopted by the City of Yuba City.
5. This activity involves lands identified as possessing significant environmental values pursuant to Public Resources Code section 6370 et seq., but such activity will not affect those significant lands. Based upon staff's consultation with the persons nominating such lands and through the CEQA review process, it is staff's opinion that the project, as proposed, is consistent with its use classification.

CALENDAR ITEM NO. **C11** (CONT'D)

APPROVALS REQUIRED:

U.S. Army Corps of Engineers
California Department of Fish and Wildlife
Central Valley Flood Protection Board
Central Valley Regional Water Quality Control Board

EXHIBITS:

- A. Land Description
- B. Site and Location Map
- C. Mitigation Monitoring Program

RECOMMENDED ACTION:

It is recommended that the Commission:

CEQA FINDING:

Find that a Mitigated Negative Declaration, State Clearinghouse No. 2013082011, and a Mitigation Monitoring Program were prepared by the City of Yuba City and adopted on August 19, 2014, for this Project and that the Commission reviewed and considered the information contained therein.

Adopt the Mitigation Monitoring Program, as contained in Exhibit C, attached hereto.

PUBLIC TRUST AND STATE'S BEST INTERESTS:

Find that the proposed lease for the construction, use, and maintenance of a new bridge with City-operated utility conduits and a 12-inch-diameter city water line at Fifth Street on the Feather River; the use of a temporary construction easement; the temporary use and maintenance of the existing Fifth Street Bridge (Bridge No. 18C-0012), also known as the Twin Cities Memorial Bridge; and the demolition and removal of the existing bridge and concrete piers will not substantially impair the public rights to navigation and fishing or substantially interfere with Public Trust needs and values at this location, at this time, or for the foreseeable term of the lease, and is consistent with the common law Public Trust Doctrine, and is in the best interests of the State.

SIGNIFICANT LANDS INVENTORY FINDING:

Find that this activity is consistent with the use classification designated by the Commission for the land pursuant to Public Resources Code section 6370 et seq.

CALENDAR ITEM NO. **C11** (CONT'D)

AUTHORIZATION:

1. Authorize acceptance of a quitclaim deed, effective October 12, 2016, of Permit No. PRC 1929.9, a Public Agency Use Permit, issued to County of Sutter.

2. Authorize issuance of a General Lease – Public Agency Use to the City of Yuba City, beginning October 13, 2016, for a term of 25 years, for the construction, use, and maintenance of a new bridge, known as the Fifth Street Bridge, with City-operated utility conduits and a 12-inch-diameter water line; use of a temporary construction easement; temporary use and maintenance of the existing Fifth Street Feather River Bridge (No. 18C-0012), also known as the Twin Cities Memorial Bridge; and the demolition and removal of the existing bridge and concrete piers, as described on Exhibit A and shown on Exhibit B (for reference purposes only), attached and by this reference made a part hereof; consideration is the public use and benefit, with the State reserving the right at any time to set a monetary rent if the Commission finds such action to be in the State's best interests.

EXHIBIT A

PRC 1929.9

LAND DESCRIPTION

A strip of submerged land 210.00 feet wide, in the bed of the Feather River, in Sutter County and Yuba County, State of California, lying 80.00 feet northerly and 130.00 feet southerly of the following described centerline;

COMMENCING at the southeast corner of "Teegarden Addition to the Town of Yuba City", filed in the Office of the County Recorder of Sutter County on June 23, 1888 in Book "T" of Deeds at Page 126, said point being at the intersection of the westerly line of Sutter Street with the northerly line of Bridge Street in said Yuba City; Thence North 49°27'07" East 483.53 feet to the waterline of the Feather River at the westerly bank and being on the arc of a curve concave southeasterly having a radius of 4032.00 feet, a radial line to said point bears North 21°28'57" West, said point being the TRUE POINT OF BEGINNING of the herein described lease; Thence northeasterly along the arc of said curve a distance of 426.94 feet, through a central angle of 06°04'01" to the waterline of the Feather River at the easterly bank and being the POINT OF TERMINATION of this description.

Sidelines of said strip shall be lengthened or shortened so as to terminate at the low water marks of said Feather River

EXCEPTING THEREFROM any portion lying landward of low water marks of said Feather River.

The basis of bearings for the above described parcel of land are referenced to the California Coordinate System, Zone 2 originating from found monuments KS1971 and KS1813 established by the National Geodetic Survey and part of the national readjustment of 2007. All distances are ground measurement.

END OF DESCRIPTION

Prepared by me or under my direction.

TERRY FLETCHER LS 5834

9/6/2016
DATE

My Registration Expires 09-30-2016

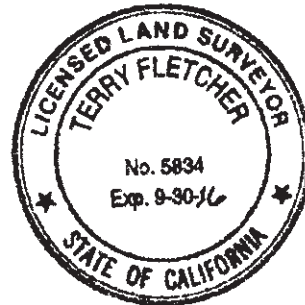

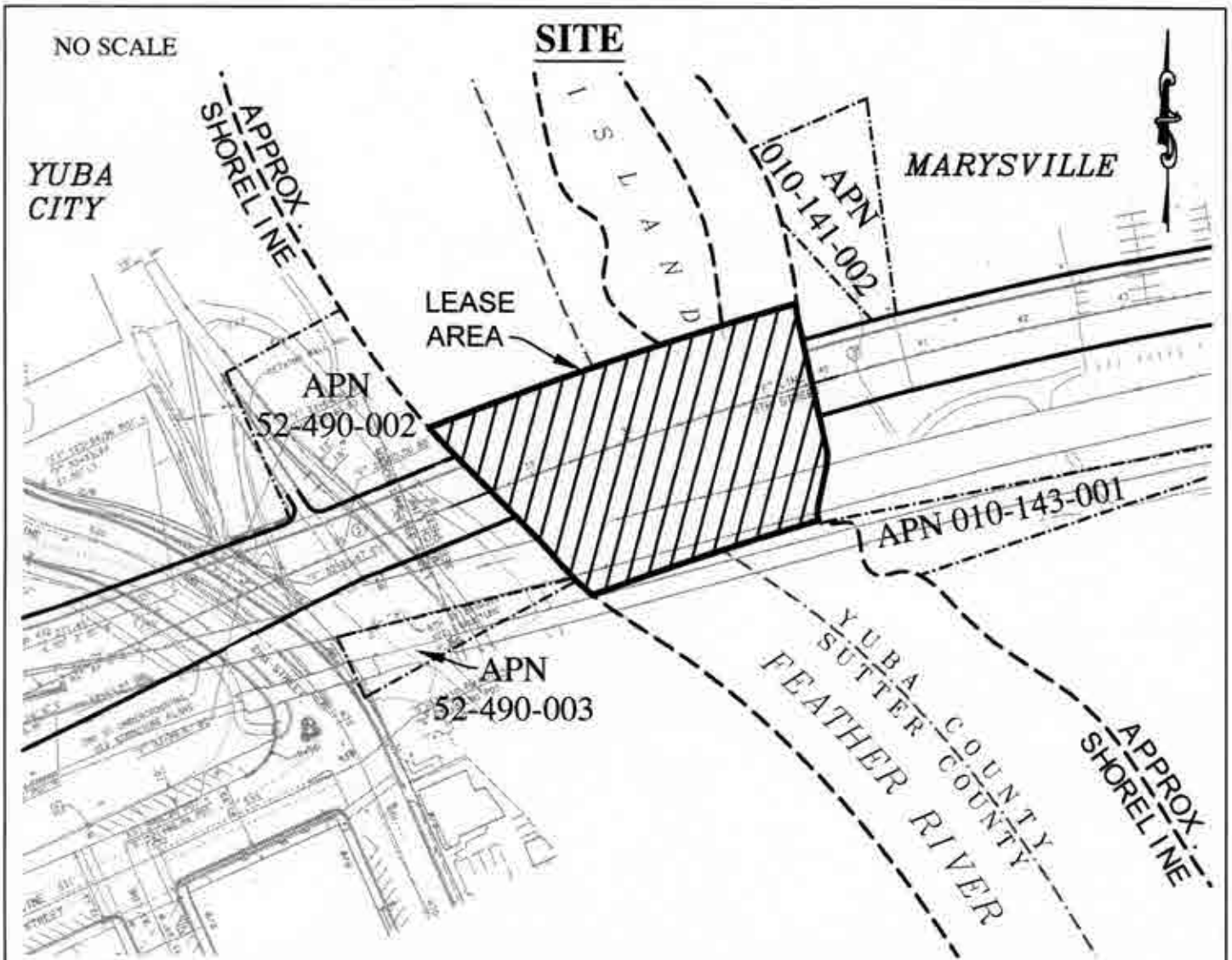

5TH STREET BRIDGE BETWEEN YUBA CITY AND MARYSVILLE

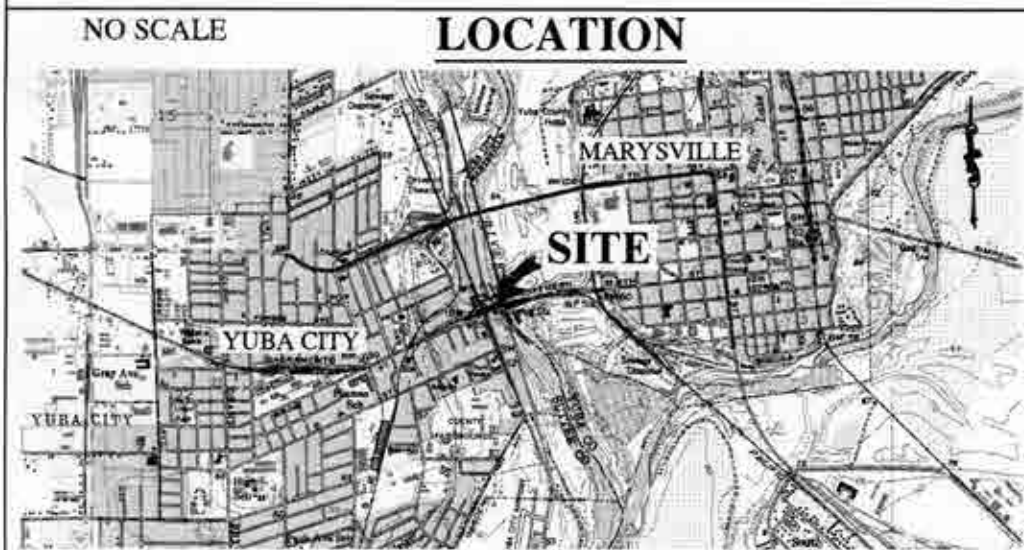

MAP SOURCE: USGS QUAD

Exhibit B
 PRC 1929.9
 YUBA CITY
 APN 52-490-002 & 003
 APN 010-143-001 & 010-141-002
 GENERAL LEASE -
 PUBLIC AGENCY USE
 SUTTER & YUBA COUNTY



This Exhibit is solely for purposes of generally defining the lease premises, is based on unverified information provided by the Lessee or other parties and is not intended to be, nor shall it be construed as, a waiver or limitation of any State interest in the subject or any other property.

EXHIBIT C
CALIFORNIA STATE LANDS COMMISSION
MITIGATION MONITORING PROGRAM
5TH STREET BRIDGE REPLACEMENT PROJECT
(PRC 1929.9, State Clearinghouse No. 2013082011)

The California State Lands Commission (Commission) is a responsible agency under the California Environmental Quality Act (CEQA) for the 5th Street Bridge Replacement Project (Project). The CEQA lead agency for the Project is the City of Yuba City.

In conjunction with approval of this Project, the Commission adopts this Mitigation Monitoring Program (MMP) for the implementation of mitigation measures for the portion(s) of the Project located on Commission lands. The purpose of a MMP is to discuss feasible measures to avoid or substantially reduce the significant environmental impacts from a project identified in an Environmental Impact Report (EIR) or a Mitigated Negative Declaration (MND). State CEQA Guidelines section 15097, subdivision (a), states in part:¹

In order to ensure that the mitigation measures and project revisions identified in the EIR or negative declaration are implemented, the public agency shall adopt a program for monitoring or reporting on the revisions which it has required in the project and the measures it has imposed to mitigate or avoid significant environmental effects. A public agency may delegate reporting or monitoring responsibilities to another public agency or to a private entity which accepts the delegation; however, until mitigation measures have been completed the lead agency remains responsible for ensuring that implementation of the mitigation measures occurs in accordance with the program.

The lead agency has adopted an MND; State Clearinghouse No. 2013082011, and adopted an Environmental Commitment Record (Mitigation Monitoring Program or MMP) for the whole of the Project (see Exhibit C, Attachment C-1) and remains responsible for ensuring that implementation of the mitigation measures occurs in accordance with its program. The Commission's action and authority as a responsible agency apply only to the mitigation measures listed in Table C-1 below. The full text of each mitigation measure, as set forth in the MMP prepared by the CEQA lead agency and listed in Table C-1, is incorporated by reference in this Exhibit C.

¹ The State CEQA Guidelines are found at California Code of Regulations, title 14, section 15000 et seq.

Table C-1. Project Impacts and Applicable Mitigation Measures*

Potential Impact	Mitigation Measure (MM) ²
Impacts from asbestos	HW-1
Impacts from lead	HW-2, HW-3
Impacts from contaminated soil excavation	HW-7
Impacts to residences	NOI-1
Impacts from construction	NOI-2, NOI-3, NOI-4
Impacts to natural communities	BIO-1, BIO-3, BIO-4, BIO-21
Impacts to trees	BIO-2, BIO-3, BIO-18
Impacts to waters of the State	BIO-5
Impacts to nesting birds	BIO-6, BIO-7, BIO-8
Impacts to western pond turtle	BIO-9, BIO-10, BIO-11
Impacts to special status fish species	BIO-12, BIO-13, BIO-14, BIO-15, BIO-16, BIO-17, BIO-18, BIO-19, BIO-20, BIO-22, BIO-23, BIO-24
Impacts from invasive species	BIO-32, BIO-33
Impacts to water-based recreation	PRF-6
Impacts to water quality	SWR-1, SWR-2, BIO-17
Impacts to air quality	AQ-1

*The lead agency adopted measures to lessen both potentially significant impacts and less-than-significant impacts. The lead agency determined that the project would have no significant adverse impacts, with mitigation incorporated, on hazardous materials, noise, and biological resources and those mitigation measures are listed first in Table C-1.

² See Attachment C-1 for the full text of each MM taken from the MMP prepared by the CEQA lead agency.

ATTACHMENT C-1

Mitigation Monitoring Program Adopted by the

City of Yuba City

Appendix E **Environmental Commitment Record**

Yuba City, as the lead agency under the California Environmental Quality Act (CEQA), has developed an Environmental Commitment Record for the 5th Street Bridge Replacement Project. This list is designed to ensure that the mitigation measures identified in the project's Initial Study/Environmental Assessment are implemented prior to, during, and after completion of construction.

The following table contains a list of the avoidance, minimization, and/or mitigation measures. For each measure, the table identifies timing of implementation, party responsible for implementation, completion check box, and space for initials.

Yuba City is responsible for ensuring the implementation of all measures in this Environmental Commitment Record.

Task and Brief Description	Timing	Responsible Party	Completed	Initials	Notes (optional)
Parks and Recreational Facilities					
<p>Measure PRF-1: Construction activities that temporarily impact the adjacent soccer field and associated parking spaces will be limited to one season of the Yuba Sutter Youth Soccer League fall season (August through November). Project construction will be staged to ensure that no area of the park's recreational features is impacted for more than 6 months total.</p>	Prior to construction	Yuba City	<input type="checkbox"/>	_____	
<p>Measure PRF-2: The City of Yuba City and the City of Marysville will coordinate with the Yuba Sutter Youth Soccer League prior to construction to ensure that construction activities and closure of one soccer field will minimally affect the main soccer season scheduled in the fall.</p>	Prior to construction	Yuba City / Marysville	<input type="checkbox"/>	_____	
<p>Measure PRF-3: Temporary, and, if necessary, permanent replacement parking will be provided at an alternative location to ensure adequate parking is provided for all major organized park activities. No permanent loss of parking would occur in the park as a result of construction of this project. The City of Marysville will coordinate to organize and direct parking through the use of signage.</p>	During construction	Resident Engineer	<input type="checkbox"/>	_____	
<p>Measure PRF-4: A temporary chain link fence will be installed by the construction contractor to provide a safety barrier between construction activities and recreational activities.</p>	During construction	Resident Engineer	<input type="checkbox"/>	_____	
<p>Measure PRF-5: After construction activities that would affect the soccer fields have been completed, the City of Marysville will relocate the one soccer field that was temporarily closed during construction to the north approximately 10 feet. This relocation is to provide adequate safety for soccer players in terms of the field's proximity to the new bridge column.</p>	During construction	Resident Engineer	<input type="checkbox"/>	_____	

Task and Brief Description	Timing	Responsible Party	Completed	Initials	Notes (optional)
<p>Measure PRF-6: During construction activities that take place in or nearby the live Feather River Channel, the following measures shall be implemented to improve safety for the public engaged in recreation along the Feather River:</p> <ul style="list-style-type: none"> • Buoys and signage shall be implemented both on the bridge and in the river to alert watercraft users of construction activities and to help watercraft navigate safe passage. • Nighttime navigational lighting shall be used as necessary to alert watercraft of changed in the river conditions during construction. • Containment or a protective cover (netting) shall be installed along the live channel used to ensure that falling debris does not endanger the public during construction activities. 	During construction	Resident Engineer	<input type="checkbox"/>	_____	
Community Character and Cohesion					
Measure CCC-1: Where feasible, temporary signage will be installed notifying the public of closures or detours and the expected duration of the closure.	Prior to construction	Yuba City	<input type="checkbox"/>	_____	
Measure CCC-2: Temporary disruptions to access for businesses in the project area will be minimized by coordinating construction to provide alternative access points and by ensuring that all businesses have at least one open driveway during construction.	During construction	Resident Engineer	<input type="checkbox"/>	_____	
Measure CCC-3: Pedestrian and bicycle access will be maintained, where facilities are currently present, on at least one side of the roadway through the project area during construction.	During construction	Resident Engineer	<input type="checkbox"/>	_____	
Relocation					
Measure RLC-1: Property owners shall be compensated in accordance with fair market values based on appraisals. The City of Yuba City will use the Caltrans standard Relocation Assistance Program to provide relocation advisory assistance to any person, business, farm or non-profit organization displaced as a result of acquisition of real property for public use.	Prior to construction	Yuba City	<input type="checkbox"/>	_____	

Task and Brief Description	Timing	Responsible Party	Completed	Initials	Notes (optional)
<p>Measure RLC-2: All efforts would be made to identify relocation opportunities for affected businesses. Wherever feasible, assistance would be made available in identifying suitable relocation sites within the service area of existing businesses.</p>	<p>Prior to construction</p>	<p>Yuba City</p>	<p><input type="checkbox"/></p>	<p>_____</p>	
Utilities/Emergency Services					
<p>Measure UTL/ES-1: To minimize interruptions of service to utility customers, a series of coordination letters shall be sent to all impacted utility companies to identify utilities within the proposed project. Letters will indicate where utility relocations are to be performed and the required time to relocate them. Design plans will be sent to involved utility owners during the project development phase. Meetings will be arranged with utility companies as necessary to discuss impacts and relocation plans.</p>	<p>Prior to construction (prepare) / During construction (implement)</p>	<p>Yuba City / Resident Engineer</p>	<p><input type="checkbox"/></p>	<p>_____</p>	
<p>Measure UTL/ES-2: A Transportation Management Plan shall be prepared. It will ensure that there is appropriately designed access for emergency services onto all roads involved in the proposed project. The transportation coordination plan will be provided to emergency public services (including fire, police, and hospital facilities).</p>	<p>Prior to construction (prepare) / During construction (implement)</p>	<p>Yuba City / Resident Engineer</p>	<p><input type="checkbox"/></p>	<p>_____</p>	
<p>Measure UTL/ES-3: Emergency public services, local law enforcement agencies, and local businesses will be notified of the proposed project and of any temporary lane closures one month before construction begins.</p>	<p>Prior to construction</p>	<p>Yuba City</p>	<p><input type="checkbox"/></p>	<p>_____</p>	
Traffic and Transportation/Pedestrian and Bicycle Facilities					
<p>Measure TRAF-1: All existing non-motorized facilities shall be maintained to ADA standards.</p>	<p>During construction</p>	<p>Resident Engineer</p>	<p><input type="checkbox"/></p>	<p>_____</p>	
<p>Measure TRAF-2: To minimize the temporary effects to travelers, a Traffic Management Plan will be prepared. Such strategies might include public information campaigns, motorist information, incident management, and inclusion of night work for construction activities.</p>	<p>Prior to construction (prepare) / During construction (implement)</p>	<p>Yuba City / Resident Engineer</p>	<p><input type="checkbox"/></p>	<p>_____</p>	

Task and Brief Description	Timing	Responsible Party	Completed	Initials	Notes (optional)
Water Quality and Stormwater Runoff					
<p>Measure SWR-1: For project areas exceeding one acre, NPDES guidelines necessitate the development of a SWPPP by the contractor prior to construction to establish project-specific permanent and temporary BMPs. During the design phase, a SWPPP will be prepared to determine the minimum control requirements to be included in the project. A Notice of Intent or Notice of Construction will be submitted to the SWRCB along with the completed SWPPP.</p>	Prior to construction	Yuba City	<input type="checkbox"/>	_____	
<p>Measure SWR-2: BMPs include any facilities and methods used to remove, reduce, or prevent storm water runoff pollutants from entering receiving waters. Erosion control methods, temporary and permanent BMPs, and improvement of drainage facilities along the roadway would minimize impacts from storm water runoff. The SWPPP and NPDES compliance measures would ensure no adverse impacts would occur to water quality associated with the Build Alternative.</p>	Prior to construction (prepare) / During construction (implement)	Yuba City / Resident Engineer	<input type="checkbox"/>	_____	
Hazardous Waste or Materials					
<p>Measure HW-1: Prior to the start of construction, asbestos surveys shall be conducted to identify presence of asbestos related materials within the project area. Surveys will include the 5th Street Bridge and any other buildings or structures that would be modified or demolished during construction.</p>	Prior to construction	Yuba City	<input type="checkbox"/>	_____	
<p>Measure HW-2: Pavement striping within the project area shall be removed in accordance with Caltrans Standard Special Provision 15-300 REMOVE TRAFFIC AND PAVEMENT MARKINGS.</p>	During construction	Resident Engineer	<input type="checkbox"/>	_____	
<p>Measure HW-3: Prior to the start of construction, lead based paint surveys shall be conducted to identify presence of lead related materials within the project area. Surveys will include the 5th Street Bridge and any other buildings or structures that would be modified or demolished during construction.</p>	Prior to construction (prepare) / During construction (implement)	Yuba City / Resident Engineer	<input type="checkbox"/>	_____	

Task and Brief Description	Timing	Responsible Party	Completed	Initials	Notes (optional)
<p>Measure HW-4: Any leaking transformers observed during the course of the project should be considered a potential polychlorinated biphenyl (PCB) hazard. Should leaks from electrical transformers (that will either remain within the constricted limits or will require removal and/or relocation) be encountered during construction, the transformer fluid should be sampled and analyzed by qualified personnel for detectable levels of PCB's. Should PCBs be detected, the transformer should be removed and disposed of in accordance with the appropriate regulatory agency. Any stained soil encountered below electrical transformers with detectable levels of PCB's should also be handled and disposed of in accordance with the appropriate regulatory agency.</p>	<p>Prior to construction (prepare) / During construction (implement)</p>	<p>Yuba City / Resident Engineer</p>	<p><input type="checkbox"/></p>	<p>_____</p>	
<p>Measure HW-5: Prior to the start of construction, a review of the most current results of the groundwater monitoring wells associated with the existing NTG, GasMax and Chevron gas stations for potentially elevated levels of petroleum hydrocarbons and MTBE contamination shall be conducted. Based on review of the groundwater monitoring well data results, if elevated levels of the groundwater monitoring wells are detected in groundwater monitoring wells that are within or immediately adjacent to the project limits a limited Phase II Site Assessment should be performed at those locations. The Phase II Site Assessment should consist of subsurface sampling and laboratory analysis and be of sufficient quantity to define the extent and concentration of contamination within the areal extent and depths of planned construction activities adjacent to the NTG, GasMax and/or Chevron gas stations. The Phase II Site Assessment should also provide both a Health and Safety Plan for worker safety and a Work Plan for handling and disposing contaminated soil during construction.</p>	<p>Prior to construction (prepare) / During construction (implement)</p>	<p>Yuba City / Resident Engineer</p>	<p><input type="checkbox"/></p>	<p>_____</p>	
<p>Measure HW-6: Prior to the start of construction, a preliminary investigation and screening for potentially elevated levels of petroleum hydrocarbon contamination, grease and oils, in the surface and near-surface soils along the project segments within 50 feet of the existing Union Pacific Railroad and former Sacramento Northern Railroad alignments shall be conducted. The investigation should include a remediation plan for handling and/or removal/disposal of contaminated soil, if encountered.</p>	<p>Prior to construction (prepare) / During construction (implement)</p>	<p>Yuba City / Resident Engineer</p>	<p><input type="checkbox"/></p>	<p>_____</p>	

Task and Brief Description	Timing	Responsible Party	Completed	Initials	Notes (optional)
<p>Measure HW-7: As is the case for any project that proposes excavation, the potential exists for unknown hazardous contamination to be revealed during project construction (such as previously undetected petroleum hydrocarbon contamination from nearby sources or potential explosive threat if a gas pipeline is ruptured during construction). For any previously unknown hazardous waste/material encountered during construction, Yuba City will follow the procedures outlined in the Caltrans Hazards Procedures for Construction.</p>	<p>Prior to construction (prepare) / During construction (implement)</p>	<p>Yuba City / Resident Engineer</p>	<p><input type="checkbox"/></p>	<p>_____</p>	
Air Quality					
<p>Measure AQ-1: The construction contractor shall comply with Caltrans' Standard Specifications in Section 14 (2010).</p> <ul style="list-style-type: none"> • Section 14-9.01 specifically requires compliance by the contractor with all applicable laws and regulations related to air quality, including air pollution control district and air quality management district regulations and local ordinances. • Section 14-9.02 is directed at controlling dust. If dust palliative materials other than water are to be used, material specifications are contained in Section 18. 	<p>During construction</p>	<p>Resident Engineer</p>	<p><input type="checkbox"/></p>	<p>_____</p>	
Noise					
<p>Measure NOI-1: Yuba City intends to incorporate noise abatement in the form of (a) barrier(s) at R24, a property located southwest of 5th Street and J Street in Marysville, with respective lengths and average heights of 170 feet length and 10 feet height. Calculations based on preliminary design data indicate that the barrier(s) would reduce noise levels by at least 7 dBA for five residences at a cost of \$78,029. If during final design conditions have substantially changed, noise abatement may not be necessary. The final decision of the noise abatement will be made upon completion of the project design and the public involvement processes.</p>	<p>During construction</p>	<p>Resident Engineer</p>	<p><input type="checkbox"/></p>	<p>_____</p>	

Task and Brief Description	Timing	Responsible Party	Completed	Initials	Notes (optional)
<p>Measure NOI-2: Yuba City will ensure that the construction contractor shall comply with Caltrans Standard Specifications Section 14-8.02, "Noise Control". Section 14-8.02 provides information that can be considered in determining whether construction would result in adverse noise impacts. The specification states:</p> <ul style="list-style-type: none"> • Do not exceed 86 dBA at 50 feet from the job site activities from 9 p.m. to 6 a.m. • Use an alternative warning method instead of a sound signal unless required by safety laws. • Construction vehicles shall equip internal combustion engines with the manufacturer recommended muffler. 	During construction	Resident Engineer	<input type="checkbox"/>	_____	
<p>Measure NOI-3: Substantial noise-generating construction activities, such as pile driving, shall be limited to daytime hours.</p>	During construction	Resident Engineer	<input type="checkbox"/>	_____	
<p>Measure NOI-4: Substantial noise-generating construction activities during periods of intensive park usage (concerts, soccer tournaments, etc.), shall be avoided.</p>	During construction	Resident Engineer	<input type="checkbox"/>	_____	
Biological Environment					
<i>Natural Communities</i>					
<p>Measure BIO-1: Prior to the start of construction, Environmentally Sensitive Area (ESA) fencing shall be installed along the construction limits to protect riparian habitat associated with the Feather River from construction activities.</p>	Prior to construction	Yuba City	<input type="checkbox"/>	_____	
<p>Measure BIO-2: All trees to remain in place within and adjacent to proposed ground disturbances shall be designated as ESA and shall be temporarily fenced with orange plastic construction (exclusion) fencing throughout all grading and construction activities. To the extent feasible, the exclusion fencing shall be installed along the dripline of trees greater than 6 inches diameter at breast height. The fencing is intended to prevent equipment operations in the proximity of protected trees that may compact soil, crush roots, or collide with the tree trunk and/or overhanging branches.</p>	Prior to construction (prepare) / During construction (implement)	Yuba City / Resident Engineer	<input type="checkbox"/>	_____	

Task and Brief Description	Timing	Responsible Party	Completed	Initials	Notes (optional)
<p>Measure BIO-3: In order to ensure that vegetated areas are restored to their pre-construction conditions, a landscaping plan will be prepared during design of the project. This plan will include all necessary landscaping to ensure that the Riverfront Park grasses are replaced and that any other landscaping areas impacted by construction will be restored.</p>	<p>During construction</p>	<p>Resident Engineer</p>	<p><input type="checkbox"/></p>	<p>_____</p>	
<p><i>Wetlands and Other Waters</i></p>					
<p>Measures BIO-4: Prior to initiating construction, Environmentally Sensitive Area (ESA) fence shall be installed along the construction limits to prevent encroachment into the riparian areas adjacent to the construction site.</p>	<p>Prior to construction (prepare) / During construction (implement)</p>	<p>Yuba City / Resident Engineer</p>	<p><input type="checkbox"/></p>	<p>_____</p>	
<p>Measures BIO-5: Prior to start of construction activities, the City of Yuba City will obtain all necessary regulatory permits for this project. These permits are expected to include a CWA Section 401 Water Quality Certification from the RWQCB, a CWA Section 402 NPDES Compliance Permit from the SWRCB, a CWA Section 404 Nationwide 14 Permit from the USACE, a Fish and Wildlife Code Section 1602 Streambed Alteration Agreement from the CDFW, and an Floodplain Encroachment Permit from the Central Valley Flood Protection Board. These permits will require appropriate mitigation for impacts to waters of the U. S. and State.</p>	<p>During construction</p>	<p>Resident Engineer</p>	<p><input type="checkbox"/></p>	<p>_____</p>	
<p><i>Animal Species</i></p>					
<p>Measures BIO-6: To ensure compliance with MBTA and CFG code, vegetation removal and initiation of construction activities should not occur during the nesting season (defined as February 15 – August 31). If this is not possible and vegetation removal or initiation of work is to occur during the nesting season, a pre-construction survey will be required. The pre-construction survey shall be performed by a qualified biologist, to determine the presence of nesting birds and ensure active nests are not directly or indirectly impacted during construction. The pre-construction survey area will include the limits of the project impact area plus a 500-foot buffer. If work is planned to begin during the nesting season (February 15 – August 31), all vegetation removal shall be completed within two weeks of the nesting survey where the survey determines no active nests are present. If the nest of a protected bird is found, the perimeter shall be flagged and a qualified biologist will</p>	<p>Prior to construction (prepare) / During construction (implement)</p>	<p>Yuba City / Resident Engineer</p>	<p><input type="checkbox"/></p>	<p>_____</p>	

Task and Brief Description	Timing	Responsible Party	Completed	Initials	Notes (optional)
<p>coordinate with USFWS and CDFW to determine an appropriate buffer distance from construction to ensure protection of the nest. The contractor shall stop work in the nesting area and is prohibited from conducting work that could disturb the nesting birds until the buffer is established (as determined by the project biologist in coordination with wildlife agencies). The buffer shall remain in the protected area until the biologist has determined that nesting activities are complete.</p>					
<p>Measures BIO-7: Construction activities shall not disturb nesting swallows. A qualified biologist shall coordinate with CDFW and USFWS to determine what construction activities, if any, can occur once nesting activities commence.</p>	During construction	Resident Engineer	<input type="checkbox"/>	_____	
<p>Measures BIO-8: If demolition of the existing 5th Street Bridge is planned to occur during the nesting season, measures shall be taken to avoid impacts to migratory swallows. To protect migratory swallows, unoccupied nests will be removed from the existing bridge structure prior to the nesting season (February 15 – August 31). During the nesting season, the bridge structure shall be maintained free from nests either through use of exclusion devices and/or the active removal of partially constructed nests. After a nest is completed, it can no longer be removed until an approved biologist has determined that all birds have fledged and the nest is no longer being used.</p>	During construction	Resident Engineer	<input type="checkbox"/>	_____	
<p>Measures BIO-9: An environmental awareness training shall be conducted prior to the onset of construction activities with construction personnel to brief them on how to recognize western pond turtle and whom to contact should any turtles be found in the work area.</p>	During construction	Resident Engineer	<input type="checkbox"/>	_____	
<p>Measures BIO-10: A preconstruction survey for western pond turtle shall be conducted by a qualified biologist within 24 hours of the start of construction activities. If western pond turtles are located within the construction area, the turtles shall be relocated out of the area and exclusion fencing shall be installed to prevent the movement of turtles back into the construction area.</p>	During construction	Resident Engineer	<input type="checkbox"/>	_____	
<p>Measure BIO-11: If any western pond turtles are found at any time during project work, construction shall stop and the animal allowed to leave the project area, or would be actively relocated by CDFW approved biologist.</p>	Prior to construction	Yuba City	<input type="checkbox"/>	_____	

Task and Brief Description	Timing	Responsible Party	Completed	Initials	Notes (optional)
<i>Threatened or Endangered Species</i>					
<p>Measure BIO-12: All construction work that will take place in the live channel shall occur between June 1-October 1 during the summer low-flow period to minimize potential exposure of juveniles to pile driving noise/vibration, and to minimize fish entrapment within cofferdams.</p>	During construction	Resident Engineer	<input type="checkbox"/>	_____	
<p>Measure BIO-13: A qualified biologist shall prepare and implement a fish salvage plan to recover any individuals entrapped in cofferdams. The fish salvage plan shall receive approval from NMFS prior to initiating any in-channel work. At a minimum, the plan will incorporate the following:</p> <ul style="list-style-type: none"> • Provide for the collection, transfer, and release of all entrapped sensitive fish by a qualified biologist to a designated location downstream of project activities; • A record of the electrical conductivity, temperature (water and air), and pH within both the enclosure and within the free flowing river; and, • Ensure all rescued sensitive fish be kept in aerated water and at appropriate temperatures at all times prior to release. 	Prior to construction (prepare) / During construction (implement)	Yuba City / Resident Engineer	<input type="checkbox"/>	_____	
<p>At a minimum, four fish rescues will be implemented as described in the prepared fish salvage plan above, and must be provided during the following activities:</p> <ul style="list-style-type: none"> • Season 1 – After partial dewatering, a rescue event following construction of each temporary encasement at Pier 2 (to include each column, three total, at Pier 2) and a rescue event at Pier 3 (to include each column, 3 total, at Pier 3); and • Season 2 – After partial dewatering, a rescue for each of the temporary water diversions (Phase 1 and Phase 2) 	Prior to construction	Yuba City	<input type="checkbox"/>	_____	
<p>Measure BIO-14: To minimize the potential for accidental spills of materials hazardous to the aquatic environment, a Spill Prevention Control and Countermeasure Plan shall be prepared.</p>					

Task and Brief Description	Timing	Responsible Party	Completed	Initials	Notes (optional)
<p>Measure BIO-15: Any piles driven into the river channel for use as a temporary construction trestle shall be installed using vibratory driving to the greatest extent possible. If use of an impact hammer cannot be avoided, a hydraulic hammer shall be used. The force of the hammer blow can be controlled with hydraulic hammers, and reducing the impact force would reduce the intensity of the resulting sound.</p>	<p>During construction</p>	<p>Resident Engineer</p>	<p><input type="checkbox"/></p>	<p>_____</p>	
<p>Measure BIO-16: Prior to construction, an acoustical monitoring plan shall be prepared by a qualified biologist. The acoustical monitoring plan shall receive approval from NMFS prior to in-channel work and shall be implemented during all vibratory and impact pile driving activities. At a minimum, the plan will incorporate the following:</p> <ul style="list-style-type: none"> • Daily acoustical monitoring by a qualified biologist during all pile driving activities; • Measurement of underwater background levels using current NMFS methodology; • Require equipment for underwater sound monitoring (hydrophone, signal amplifier, and calibrator) to utilize current National Institute of Standards and Technology traceable calibration methodology; • Require a minimum recordation distance of 10 meters from each pile being monitored; and, • The monitoring biologist may stop work if observed migrating fish are stunned or otherwise directly impacted by noise and vibration from pile driving. Work shall not resume until the fish clears the construction area under its own power, or through collection and release by the qualified fish biologist. 	<p>Prior to construction</p>	<p>Yuba City</p>	<p><input type="checkbox"/></p>	<p>_____</p>	

Task and Brief Description	Timing	Responsible Party	Completed	Initials	Notes (optional)
<p>Measure BIO-17: Contract specifications will include the following BMPs, where applicable, to reduce erosion during construction.</p> <ul style="list-style-type: none"> • Implementation of the Project will also require approval of a site-specific SWPPP that would implement effective measures to protect water quality, which may include a hazardous spill prevention plan and additional erosion prevention techniques. • Scheduling. A specific work schedule will be implemented to coordinate the timing of land disturbing activities and the installation of erosion and sedimentation control practices to reduce on-site erosion and off-site sedimentation. • Preservation of Existing Vegetation. In addition to measures #5 above, existing vegetation shall be protected in place where feasible to provide an effective form of erosion and sediment control, as well as watershed protection, landscape beautification, dust control, pollution control, noise reduction, and shade. • Mulching. Loose bulk materials shall be applied to the soil surface as a temporary cover to reduce erosion by protecting bare soil from rainfall impact, increasing infiltration, and reducing runoff. • Soil Stabilizers. Stabilizing materials shall be applied to the soil surface to prevent the movement of dust from exposed soil surfaces on construction sites as a result of wind, traffic, and grading activities. • Slope Roughening/Terracing/Rounding. Roughening and terracing will be implemented to create unevenness on bare soil through the construction of furrows running across a slope, creation of stair steps, or by utilization of construction equipment to track the soil surface. Surface roughening or terracing reduces erosion potential by decreasing runoff velocities, trapping sediment, and increasing infiltration of water into the soil, aiding in the establishment of vegetative cover from seed. 	<p>Prior to construction (prepare) / During construction (implement)</p>	<p>Yuba City / Resident Engineer</p>	<p><input type="checkbox"/></p>	<p>_____</p>	

Task and Brief Description	Timing	Responsible Party	Completed	Initials	Notes (optional)
<p>Measure BIO-18: The City shall prepare a riparian restoration plan to be reviewed and approved by CDFW, the CVFPB, and any other applicable agencies. This plan will include restoration of areas impacted by the proposed project, as well as areas that have been disturbed from previous activities or events.</p>	Prior to construction	Yuba City	<input type="checkbox"/>	_____	
<p>Measure BIO-19: In-channel work shall not be conducted at night to afford fish quiet, unobstructed passage during night time migratory hours.</p>	During construction	Resident Engineer	<input type="checkbox"/>	_____	
<p>Measure BIO-20: The number and size of piles will be limited to the minimum necessary to meet the engineering and design requirements of the project.</p>	Prior to construction	Yuba City	<input type="checkbox"/>	_____	
<p>Measure BIO-21: Prior to initiating construction, environmentally sensitive area fencing will be installed along the construction limits to prevent encroachment into the riparian areas adjacent to the construction site.</p>	Prior to construction	Yuba City	<input type="checkbox"/>	_____	
<p>Measure BIO-22: Project activities that may affect the flow of the river through placement of fill, bridge construction, or dewatering of the channel must comply with the 2001 <i>NMFS Guidelines for Salmonid Passage at Stream Crossings</i>, where applicable. The guidelines include but are not limited to:</p> <ul style="list-style-type: none"> • A minimum water depth (12 inches for adults and six inches for juveniles) at low fish passage; • A maximum hydraulic drop of one foot for adults and six inches for juveniles; • Avoidance of abrupt changes in water surface and velocities; and, • Structures shall be aligned with the stream, with no abrupt changes in flow direction upstream or downstream of the crossing. 	During construction	Resident Engineer	<input type="checkbox"/>	_____	

Task and Brief Description	Timing	Responsible Party	Completed	Initials	Notes (optional)
<p>Measure BIO-23: All water pumped or otherwise withdrawn from the river must comply with <i>1997 NMFS Fish Screening Criteria for Anadromous Salmonids</i>, where applicable, to avoid entrapment of the fish. The criteria include but are not limited to the following:</p> <ul style="list-style-type: none"> • Screen design must provide for uniform flow distribution over the surface of the screen; • Screen material openings must not exceed 3/32 inch for fry sized salmonids and shall not exceed 1/4 inch for fingerling sized salmonids; • Where physically practical, the screen must be constructed at the diversion entrance. The screen face should be generally parallel to river flow and aligned with the adjacent bankline; and, • The design approach velocity must not exceed 0.33 feet per second for fry sized salmonids or 0.8 feet per second for fingerling sized salmonids; and the screen design must provide for uniform flow distribution over the surface of the screen. <p>It is anticipated that the exact specification requirements for fish screening equipment will be determined by the on-site fish biologist monitor in accordance with the 1997 NMFS criteria described above.</p>	<p>During construction</p>	<p>Resident Engineer</p>	<p><input type="checkbox"/></p>	<p>_____</p>	
<p>Measure BIO-24: A bubble curtain shall be utilized to attenuate noise and vibration when other, more effective attenuation cannot be provided (such as a dewatered coffer dam).</p>	<p>During construction</p>	<p>Resident Engineer</p>	<p><input type="checkbox"/></p>	<p>_____</p>	
<p>Measure BIO-25: The City of Yuba City will compensate for the effects of the proposed project on the beetle by transplanting 12 elderberry shrubs during the recommended transplant window, November 1 to February 15. The shrubs will be transplanted to the River Ranch Conservation Bank, or another USFWS approved conservation bank, and a total of 10 VELB mitigation credits will be purchased.</p>	<p>Prior to construction (prepare) / During construction (implement)</p>	<p>Yuba City / Resident Engineer</p>	<p><input type="checkbox"/></p>	<p>_____</p>	
<p>Measure BIO-26: If any of the 12 elderberry shrubs that are proposed for transplantation are unlikely to survive transplantation because of poor condition or if any of the shrubs cannot be safely removed due to access problems since they are in such close association with the existing 5th Street Bridge, the proposed compensation ratios will be doubled (for that individual shrub) to offset the additional habitat loss.</p>	<p>Prior to construction (prepare) / During construction (implement)</p>	<p>Yuba City / Resident Engineer</p>	<p><input type="checkbox"/></p>	<p>_____</p>	

Task and Brief Description	Timing	Responsible Party	Completed	Initials	Notes (optional)
<p>Measure BIO-27: Due to the proximity of the 13 avoided elderberry shrubs to the existing bridge and railroad structure, a 20-foot construction zone will not be feasible during demolition activities. Therefore, a modified construction zone will be installed by placing fencing around each elderberry shrub. The fencing will be placed at the drip line of each shrub in closest proximity to the existing bridge or railroad structure and will taper out to the 20-foot zone recommended for the remainder. A USFWS approved biologist will be present during the installation of fencing.</p>	During construction	Resident Engineer	<input type="checkbox"/>	_____	
<p>Measure BIO-28: Prior to the commencement of construction activities, fencing will be installed along Environmentally Sensitive Area (ESA) boundaries to prevent encroachment into the riparian areas adjacent to the construction site.</p>	Prior to construction	Yuba City	<input type="checkbox"/>	_____	
<p>Measure BIO-29: Contractors will be provided with environmental awareness training, which will brief them on the need to avoid damage to the elderberry shrubs and the possible penalties for not complying with these requirements.</p>	Prior to construction	Yuba City	<input type="checkbox"/>	_____	
<p>Measure BIO-30: A USFWS approved biologist will periodically monitor construction activities to ensure elderberry shrubs within the action area are not disturbed.</p>	During construction	Resident Engineer	<input type="checkbox"/>	_____	
<p>Measure BIO-31: Elderberry shrubs within 100 feet of construction activities will be rinsed with clean water once each week, or when necessary to remove dust caused by construction activities.</p>	During construction	Resident Engineer	<input type="checkbox"/>	_____	
<i>Invasive Species</i>					
<p>Measures BIO-32: All landscaping and revegetation shall consist of Yuba City approved plants or seed mixes from native, locally adapted species.</p>	Prior to construction (prepare) / During restoration (implement)	Yuba City	<input type="checkbox"/>	_____	
<p>Measures BIO-33: Prior to arrival at the project site and prior to leaving the project site, construction equipment that may contain invasive plants and/or seeds shall be cleaned to reduce the spreading of noxious weeds.</p>	During Construction	Yuba City	<input type="checkbox"/>	_____	
Climate Change under the California Environmental Quality Act					
<p>Measure GHG-1: Energy efficient lighting, such as LED traffic signals and street lights, will be used when possible.</p>	Prior to construction (prepare) / During construction (implement)	Yuba City / Resident Engineer	<input type="checkbox"/>	_____	