

**STAFF REPORT
C03**

A 1
S 1

08/23/18
PRC 4195.1
S. Evans

REVISION OF RENT

LESSEE:

Brockway Shores

AREA, LAND TYPE, AND LOCATION:

Sovereign land in Lake Tahoe, adjacent to 144 Chipmunk, near Brockway, Placer County.

AUTHORIZED USE:

Continued use and maintenance of an existing pier, 20 mooring buoys, and two marker buoys.

LEASE TERM:

10 years, beginning September 28, 2013.

CONSIDERATION:

This lease provides that the Commission may modify the rent periodically during the lease term. Pursuant to this provision, staff reviewed the rent under this lease and recommends that rent be revised from \$8,863 per year to \$8,938 per year, effective September 28, 2018.

OTHER PERTINENT INFORMATION:

1. On February 21, 2014, the Commission authorized a General Lease – Recreational Use to Brockway Shores for a term of 10 years beginning September 28, 2013 ([Item C35, February 21, 2014](#)). The lease will expire on September 27, 2023.
2. The rent is being revised to apply the updated rate to the marker buoys.
3. This revision of rent is consistent with Strategy 2.2 of the Commission’s Strategic Plan to ensure timely receipt of revenues and royalties from the use and development of State lands and minerals.

STAFF REPORT NO. **C03** (CONT'D)

4. Approving the revision of rent is not a project as defined by the California Environmental Quality Act because it is an administrative action that will not result in direct or indirect physical changes in the environment.

Authority: Public Resources Code section 21065 and California Code of Regulations, title 14, section 15378, subdivision (b)(5).

EXHIBIT:

- A. Site and Location Map

RECOMMENDED ACTION:

It is recommended that the Commission:

AUTHORIZATION:

Approve the revision of rent for Lease No. PRC 4195.1 from \$8,863 per year to \$8,938 per year, effective September 28, 2018.

NO SCALE

SITE

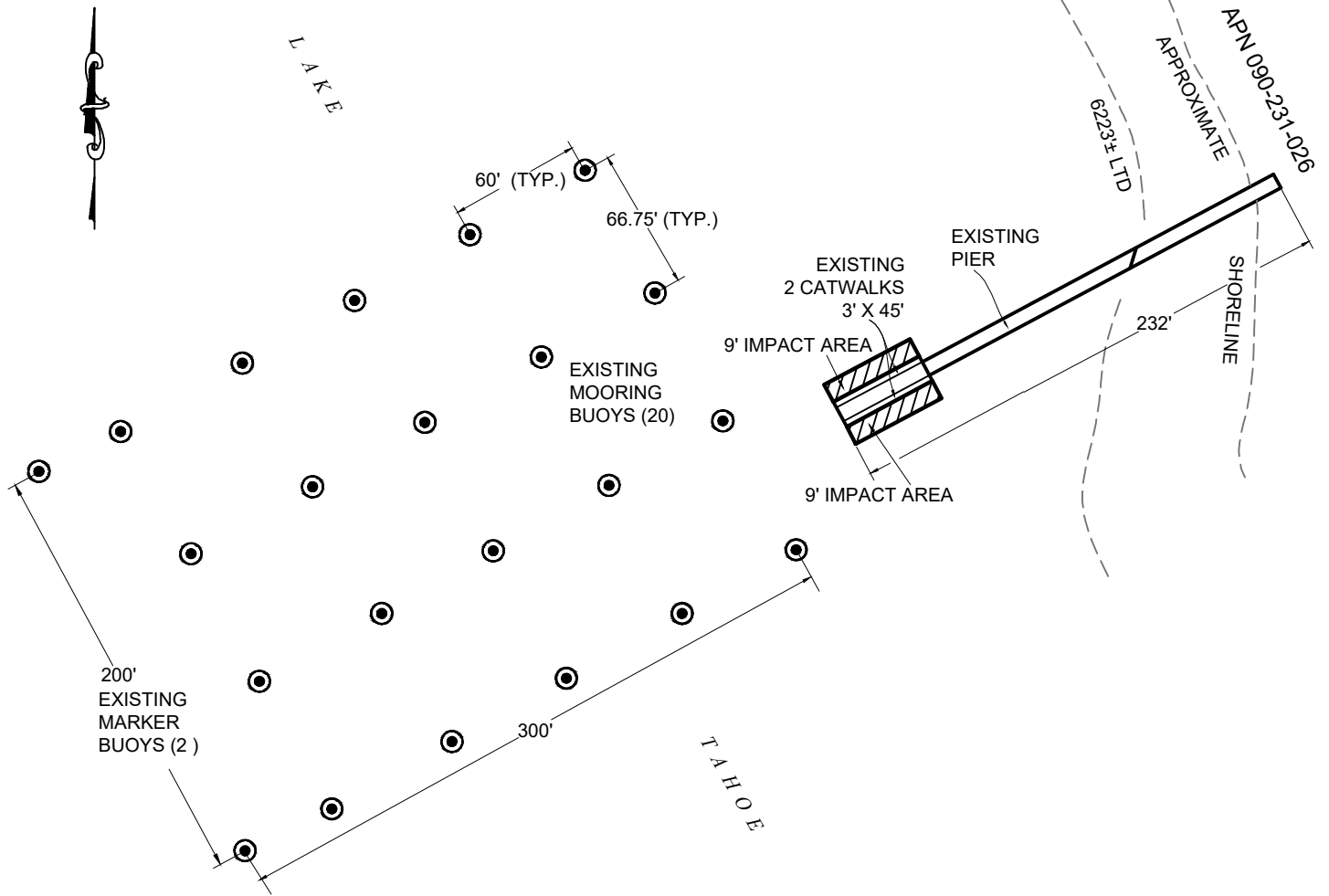

ADJACENT TO APN 090-231-026, NEAR BROCKWAY

NO SCALE

LOCATION



MAP SOURCE: USGS QUAD

Exhibit A

PRC 4195.1
 BROCKWAY SHORES
 APN 090-231-026
 GENERAL LEASE -
 RECREATIONAL USE
 PLACER COUNTY

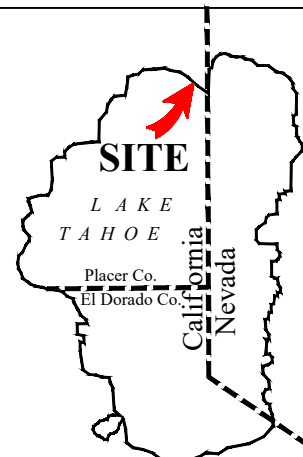

This Exhibit is solely for purposes of generally defining the lease premises, is based on unverified information provided by the Lessee or other parties and is not intended to be, nor shall it be construed as, a waiver or limitation of any State interest in the subject or any other property.